

# GIS Electric Chain Hoists

- 250 ~ 5,000 kg Lifting Capacity
- Single or Three Phase Supply
- Fixed, Manual or Motorized Trolley
- Single or Two Speed
- Compact and Rugged Design

**Swiss  
Quality**



**Exceptional  
Value**



# GIS Electric Chain Hoists

## PERFORMANCE THAT LASTS

1. **Eyebolt suspension:** An eyebolt suspension is standard with motorized and plain trolleys and upper hook type suspension with plain hoists is also standard. Unlike rigid suspensions, the eyebolt suspension allows the hoist to pivot and align itself to the direction of the load pull, reducing stress and wear.
2. **Overload slip clutch:** Long lasting asbestos free slipping clutch in the first gear stage insures the hoist is protected from overloads.
3. **Gearing:** Compact multistage transmission with helical gearing provides smooth, quiet operation. All gears are hardened for long life and are lubricated with semi-liquid oil thus making oil leaks very unlikely.
4. **Chain guide:** Hardened chain guide with five pockets, optimally suited to GIS chain. The "floating" alignment of the guide insures smooth jam free operation.
5. **Load chain and hook:** High tensile GIS special chain is calibrated, fatigue resistant, case hardened and zinc plated. High tensile steel load hook is according to DIN 15401 with large jaw opening and safety catch.
6. **Motors:** GIS cylindrical squirrel cage, TENV motors with standard class "F" insulation have extremely high duty cycle and switching frequency ratings even under tough conditions. Two speed motors are available with up to 6:1 high to low speed ratio providing excellent positioning sensitivity.
7. **Brake:** Wear resistant dry multi-disc brakes allows for frequent operations due to their stacked disc design. This system eliminates the breakage commonly found in fiber discs and solenoid type brakes.
8. **Electrical controls:** Low 42 Volt contactor system with mechanical interlock, including transformer and integrated limit switches gives optimal safety for the operator. GIS hoist and control enclosure is NEMA 3R rated for outdoor duty. Pendants are available with 2 or 4 button control with E-Stop. Pendant cables have a built-in strain relief cable.
9. **Limit switches:** All hoists are fitted with both a high and low limit switch, these are activated by the hook and end stop.

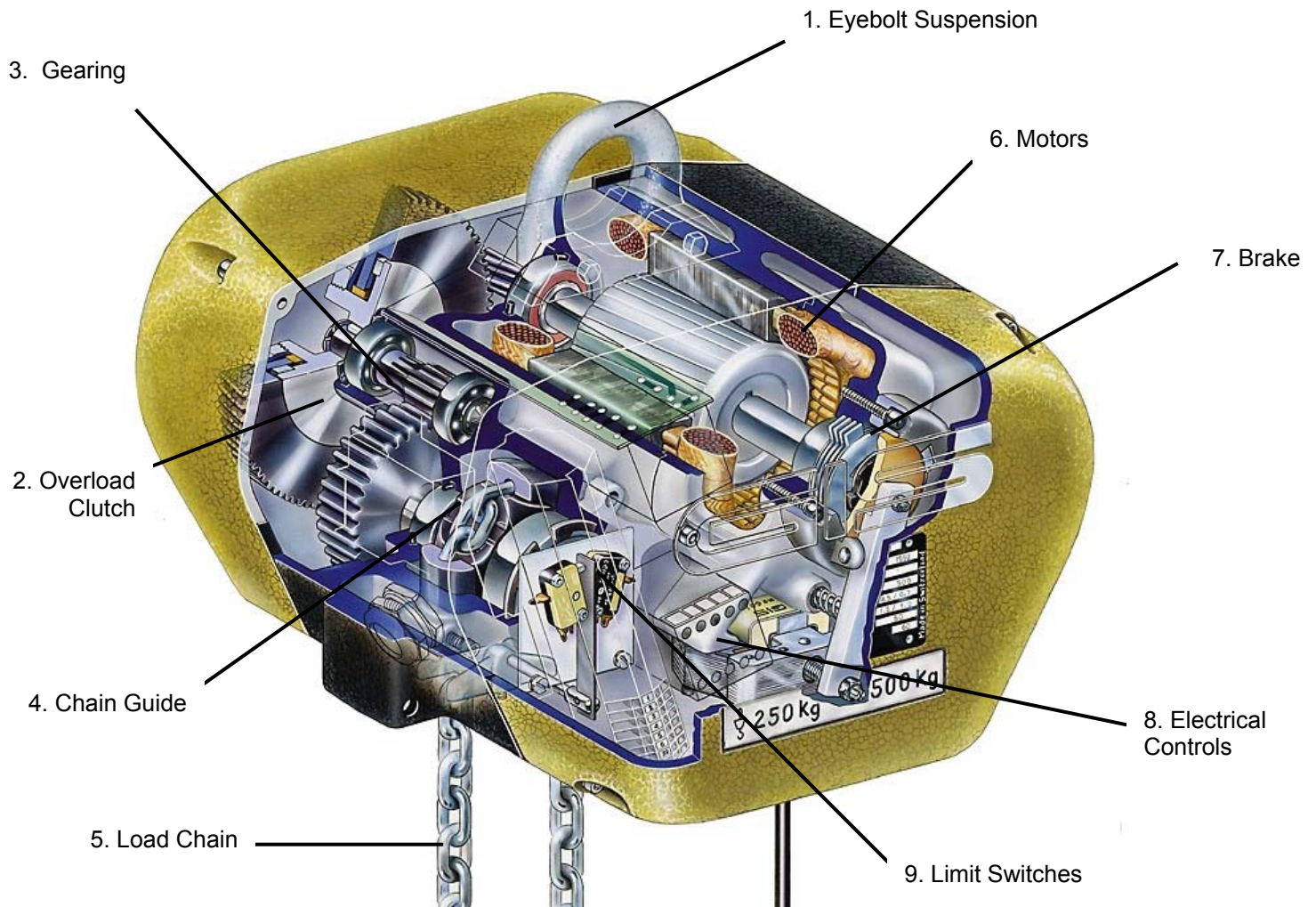

# GIS Electric Chain Hoists

## Three Phase Single Speed

**PERFORMANCE THAT LASTS**

Model	Cap. (kg)	Chain Falls	Lift Speed (fpm)	Motor HP	Amperage			Min. Curve Radius (in)	Flange <sup>1)</sup> Width (in)	Weight <sup>2)</sup> (lbs)
					230V	460V	575V			
EM25/1N	250	1	32	0.58	3.18	1.59	1.27	36	2.00~4.00	45
EM25/2N	500	2	16	0.58	3.18	1.59	1.27	36	2.00~4.00	54
EM50/1N	500	1	36	1.32	4.16	2.08	1.66	36	2.00~4.00	48
EM50/2N	1000	2	18	1.32	4.16	2.08	1.66	36	2.00~4.00	54
EM100/1N	1000	1	32	2.33	7.33	3.67	2.93	48	3.00~5.50	91
EM100/2N	2000	2	16	2.33	7.33	3.67	2.93	48	3.00~5.50	104
EM200/2N	3000	2	16	3.89	11.90	5.95	4.76	60	4.75~7.00	172
EM500/2N	5000	2	12	4.99	15.27	7.63	6.11	60	4.75~7.00	180

## Three Phase Two Speed

Model	Cap. (kg)	Chain Falls	Lift Speed (fpm)	Motor HP	Amperage			Min. Curve Radius (in)	Flange <sup>1)</sup> Width (in)	Weight <sup>2)</sup> (lbs)
					230V	460V	575V			
EM25/1NF	250	1	32/6	0.58/0.11	3.18	1.59	1.27	36	2.00~4.00	45
EM25/2NF	500	2	16/3	0.58/0.11	3.18	1.59	1.27	36	2.00~4.00	56
EM50/1NF	500	1	36/6	1.32/0.23	4.16	2.08	1.66	36	2.00~4.00	54
EM50/2NF	1000	2	18/3	1.32/0.23	4.16	2.08	1.66	36	2.00~4.00	60
EM100/1NF	1000	1	32/8	2.33/0.58	7.33	3.67	2.93	48	3.00~5.50	104
EM100/2NF	2000	2	16/4	2.33/0.58	7.33	3.67	2.93	48	3.00~5.50	108
EM200/2NF	3000	2	16/3	3.89/0.80	11.90	5.95	4.76	60	4.75~7.00	176
EM500/2NF	5000	2	12/3	4.99/1.03	15.27	7.63	6.11	60	4.75~7.00	184

## Single Phase Single Speed

Model	Cap. (kg)	Chain Falls	Lift Speed (fpm)	Motor HP	Amperage		Min. Curve Radius (in)	Flange <sup>1)</sup> Width (in)	Weight <sup>2)</sup> (lbs)
					115V	230V			
EM50/1N1PH	250	1	36	0.70	13	6.7	36	2.00~4.00	54
EM50/2N1PH	500	2	18	0.70	13	6.7	36	2.00~4.00	60
EM50/1NL1PH	500	1	18	0.70	13	6.7	36	2.00~4.00	54
EM50/2NL1PH	1000	2	9	0.70	13	6.7	36	2.00~4.00	60

## Three Phase Motorized Trolleys

Model	Cap. (kg)	Travel Speed (fpm)	Motor HP	Amperage			Min. Curve Radius (in)	Flange <sup>1)</sup> Width (in)	Weight <sup>2)</sup> (lbs)
				230V	460V	575V			
EMFE50/N	1000	47	0.40	1.6	0.79	0.63	36	2.00~4.00	60
EMFE50/NF	1000	47/16	0.24/0.07	1.3/1.5	0.65/0.74	0.52/0.59	36	2.00~4.00	60
EMFE150/N	2000	47	0.40	1.6	0.79	0.63	36	3.00~5.50	68
EMFE150/NF	2000	47/16	0.24/0.07	1.3/1.5	0.65/0.74	0.52/0.59	36	3.00~5.50	68
EMFE300/N	4000	47	0.40	1.6	0.79	0.63	48	4.75~7.00	110
EMFE300/NF	4000	47/16	0.24/0.07	1.3/1.5	0.65/0.74	0.52/0.59	48	4.75~7.00	110
EMFE500/N	5000	47	2x 0.40	2x 1.6	2x 0.79	2x 0.63	60	4.75~7.00	127
EMFE500/NF	5000	47/16	2x 0.24/0.07	2x 1.3/1.5	2x 0.65/0.74	2x 0.52/0.59	60	4.75~7.00	127

- 1) Other flange widths on request  
2) Based on 10 ft lift

# GIS Electric Chain Hoists

## PERFORMANCE THAT LASTS

Model	Cap (kg)	Eye Bolt AE	Hook AH	Push Trolley AP	Motor Trolley AM	B	C	D	E	F	G	H	I	J	K	L	M	N	O	P	Q	R	S	T	U	V	W	X	Y	Z	
<b>Three Phase (Single &amp; Two Speed)</b>																															
EM25/1	250	15.59	17.52	17.52	17.52	0.87	1.06	1.06	1.57	0.63	10.94	7.24	6.10	5.63	2.13	0.71	10.04	4.13	8.46	7.20	3.48	3.43	4.06	10.55	8.27	2.63	3.03	3.70	8.46	2.20	
EM25/2	500	15.35	17.28	17.68	17.68	0.87	1.06	1.06	1.57	0.63	10.94	7.24	6.10	6.42	2.13	0.94	10.04	4.13	8.46	7.20	3.48	3.43	4.06	10.55	8.27	2.63	3.03	3.70	8.46	2.20	
EM50/1	500	16.18	18.39	18.11	18.11	1.02	1.10	1.14	1.57	0.63	10.94	7.24	6.10	5.83	2.13	0.12	10.04	4.13	8.46	7.20	3.48	3.43	4.06	10.55	8.27	2.63	3.03	3.70	8.46	2.20	
EM50/2	1000	16.22	18.43	18.15	18.15	1.02	1.10	1.14	1.57	0.63	10.94	7.24	6.10	6.61	2.13	0.08	10.04	4.13	8.46	7.20	3.48	3.43	4.06	10.55	8.27	2.63	3.03	3.70	8.46	2.20	
EM100/1	1000	19.09	21.54	21.42	21.42	1.18	1.14	1.18	2.05	0.79	12.36	9.13	7.28	8.15	3.03	4.61	12.68	4.76	9.84	9.06	4.04	4.07	5.35	10.63	8.35	3.19	3.63	4.02	9.84	1.54	
EM100/2	2000	22.04	24.49	24.37	24.37	1.18	1.14	1.18	2.05	0.79	12.36	9.13	7.28	9.53	3.03	1.65	12.68	4.76	9.84	9.06	4.04	4.07	5.35	10.63	8.35	3.19	3.63	4.02	9.84	1.54	
EM200/2	3000	26.46	26.40	27.60	27.60	1.50	1.30	1.57	2.95	0.47	15.12	9.45	7.28	10.12	5.39	1.46	13.07	5.94	12.28	11.42	4.04	5.20	7.56	10.83	8.54	4.00	5.92	4.61	12.28	0.31	
EM500/2	5000	26.73	26.67	27.87	27.87	1.50	1.30	1.57	2.95	0.47	15.12	9.45	7.28	10.12	5.39	1.46	13.07	5.94	12.28	11.42	4.04	5.20	7.56	10.83	10.83	4.00	5.92	4.61	12.28	0.31	
<b>Single Phase (Single Speed)</b>																															
EM50/1N1PH	250	16.18	18.39	18.11	18.11	1.02	1.10	1.14	1.57	0.63	10.94	7.24	6.10	5.83	2.13	0.12	10.04	4.13	8.46	7.20	3.48	3.43	4.06	-	-	-	-	-	-	-	
EM50/2N1PH	500	16.22	18.43	18.15	18.15	1.02	1.10	1.14	1.57	0.63	10.94	7.24	6.10	6.61	2.13	0.08	10.04	4.13	8.46	7.20	3.48	3.43	4.06	-	-	-	-	-	-	-	
EM50/1NL1PH	500	16.18	18.39	18.11	18.11	1.02	1.10	1.14	1.57	0.63	10.94	7.24	6.10	5.83	2.13	0.12	10.04	4.13	8.46	7.20	3.48	3.43	4.06	-	-	-	-	-	-	-	
EM50/2NL1PH	1000	16.22	18.43	18.15	18.15	1.02	1.10	1.14	1.57	0.63	10.94	7.24	6.10	6.61	2.13	0.08	10.04	4.13	8.46	7.20	3.48	3.43	4.06	-	-	-	-	-	-	-	

Notes: All dimensions in inches.

Special trolley widths on request.

Above dimensions are based on a 10 foot lift. Longer lifts may affect the chain container size. Please consult the factory.

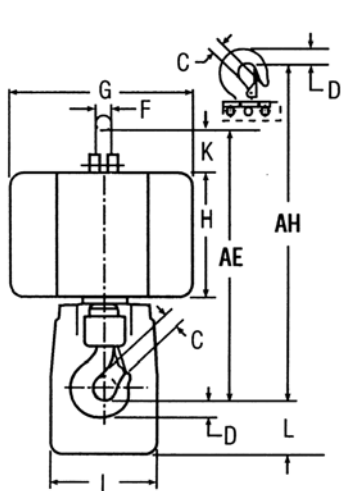

Eyebolt and Hook suspension

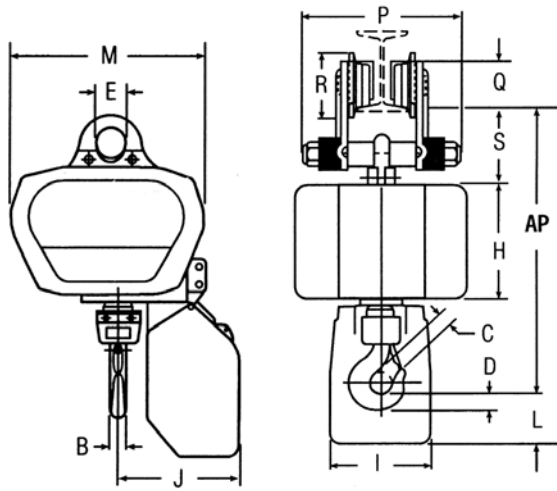

Plain Trolley with Hook Suspension

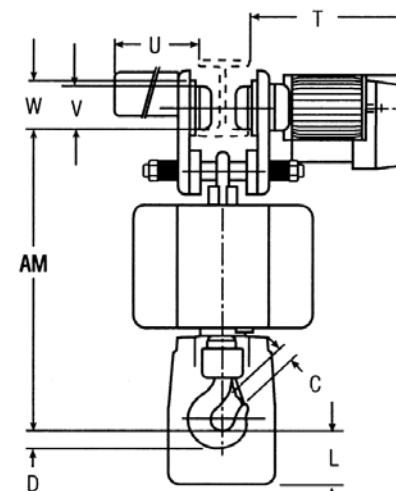
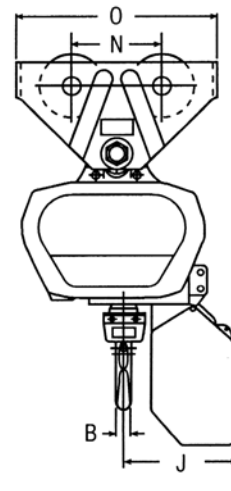

Motorized Trolley Suspension

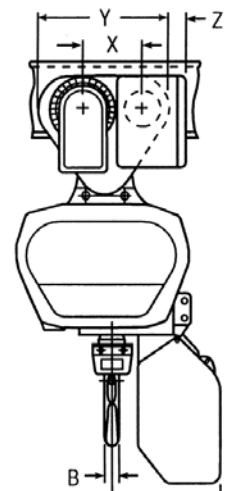

# Complete Systems



Bridge Cranes



Light Rail Jib Cranes



Beam Style Jib Cranes



Enclosed Track Systems